

Series 25(a) Direct Mount 2-Piece

Full Port Ball Valve

1/4" - 1" (DN8 - DN25)

2000 psi (PN140)

1 1/4" - 2" (DN32 - DN50)

1500 psi (PN100)

2 1/2" - 3" (DN65 - DN80)

1000 psi (PN63)



2014/68/EU



SAFETY

Ball Valve Feature Direct Mount

PVS FLOW CONTROL Series 25(a) ball valves feature direct mounting pad, exclusive stem design, and other unique supporting parts to meet customer's requirement. The direct mounting pad is constructed with two patterns, which in comply with the ISO 5211 standard.

The exclusive stem design makes Series 25(a) ball valves more competitive. The self-adjusting stem packing design with Belleville springs can prevent temperature fluctuation and valve vibration, and thus, creates a secure valve use. The stem seal are specially designed to be 45-degree against the valve body, which increases the effectiveness of the valve. In addition, stems are modeled to be blowout-proof, with the upside down insertion.

Series 25(a) ball valves also come with various parts. PVS FLOW CONTROL provides a wide ranges seat and seal with various material to choose from. All of our valve bodies are investment casting with retraceable furnace number, and also solution annealed for highest quality and strength. The ball designs of the Series 25(a) valves are floating-ball method; the valve ball is floating inside the valve body, and lean towards the downstream flow direction. The result presents a strong

sealing effect under both low and high pressures.

Other features include API 598 testing and inspection regulations, in which every valve will undergo a series of inspections by our quality assurance engineer to achieve the highest conformity rate.

Valve Body Rating with Seat Material Plot:

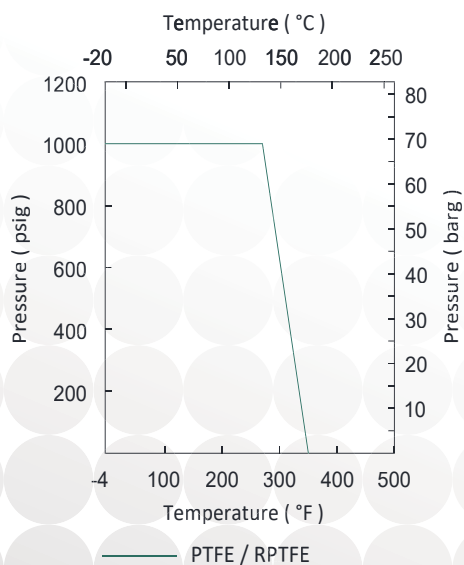

This table express Seat material resistance as declared by the original manufacturers. The values are to be considered with other parameters such as size, seat design and temperature limitations as governed by relevant standards such as ASME B16.34 or EN12516-1.

CE marking

The whole series of ball valves are approved according to European Directive 2014/68/EU.

SIL3 Capable Please inquire



Direct Mounting Pad

The Series 25(a) ball valves are constructed with twin ISO 5211-complied mounting pads, which provide possibilities of actuators.

Stem Packing Design

The self-adjusting stem packing design will avoid temperature fluctuation and valve vibrations. This design also includes blowout-proof stem design.

Comprehensive Parts Supply

PVS FLOW CONTROL Series 25(a) ball vales come with different type of material for seal and seat to meet our customer's specification.

Pressure Rating

2000 psi (PN140)
1500 psi (PN100)
1000 psi (PN63)
150 psi (10 bar) with saturated steam

Temperature Range:

-20°F to 350°F (-28°C to 180°C) with PTFE/RPTFE

End Connection:

Threaded

Body Material:

ASTM CF8M, CF8, WCB
(DIN 1.4408, 1.4308, 1.0619)

Size Range:

1/4"~3" (DN8~DN80)

Standards and Specifications

Female Type ASME B16.20 length meets
BSPP ISO 228-1
BSPT ISO 10226-1 / ISO 7-1

Valve body and end cap connections are high quality investment cast. Both stainless steel material and carbon steel are solution annealed and normalized to ensure the highest quality.

Series 25(a) 2pc Ball Valve

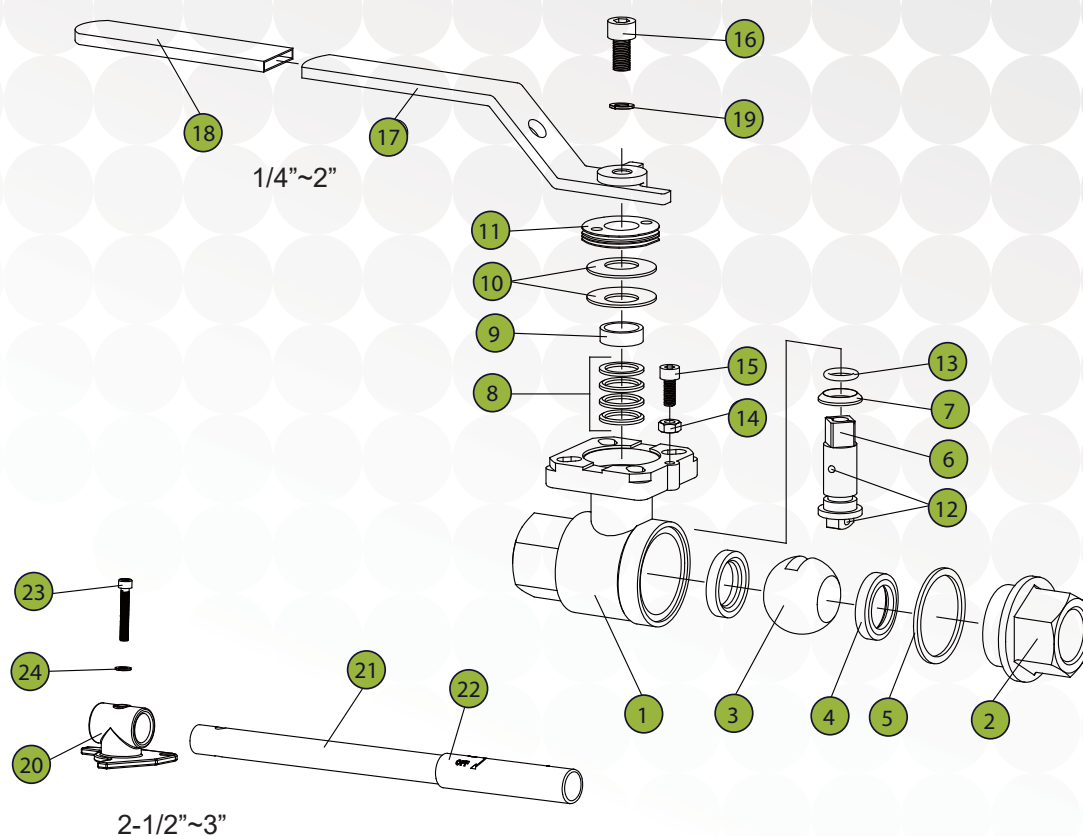

NO	PART NAME	MATERIAL
1	BODY	CF8M / 1.4408
2	CAP	CF8M / 1.4408
3	BALL	CF8M
4	BALL SEAT	PTFE
5	BODY SEAL	PTFE
6	STEM	SS316
7	THRUST WASHER	PTFE
8	STEM PACKING	PTFE
9	GLAND	SS304
10	BELLEVILLE WASHER	SS301
11	DISC PLATE	SS304
12	ANTI-STATIC DEVICE	SS316

NO	PART NAME	MATERIAL
13	O-RING	VITON
14	STOP NUT	SS304
15	STOP BOLT	SS304
16	HANDLE BOLT	SS304
17	HANDLE	CF8
18	HANDLE SLEEVE	VINYL
19	HANDLE WASHER	SS304
20	HANDLE ADAPTOR	CF8
21	HANDLE PIPE	CARBON
22	HANDLE PIPE SLEEVE	VINYL
23	ADAPTOR BOLT	SS304
24	ADAPTOR WASHER	SS304

Dimensions inch/mm

SIZE Inch DN	d	L	H1	H2	S	Cv Kv	Weight (kg)	TQ in-lbs/ N.m	ISO 5211
1/4" 8	0.44 11.2	2.56 65	1.65 42	0.28 7	0.35 9	8 6.84	0.4	45/5	F03/F04
3/8" 10	0.5 12.6	2.56 65	1.65 42	0.28 7	0.35 9	10 8.55	0.4	45/5	F03/F04
1/2" 15	0.59 15	3 75	1.65 42	0.28 7	0.35 9	13 11.1	0.48	60/7	F03/F04
3/4" 20	0.78 20	3.15 80	1.77 45	0.31 8	0.35 9	50 42.7	0.56	80/9	F03/F04
1" 25	1 25	3.54 90	2.05 52	0.39 10	0.43 11	93 79.5	0.75	130/15	F04/F05
1 1/4" 32	1.26 32	4.3 110	2.24 57	0.22 14	0.43 11	170 145.3	1.48	160/18	F04/F05
1 1/2" 40	1.5 38	4.72 120	2.67 68	0.52 14	0.55 14	250 213.7	2.32	200/23	F05/F07
2" 50	2 50	5.5 140	3 77	0.52 14	0.55 14	450 384.6	3.8	280/32	F05/F07
2 1/2" 65	2.5 65	7.3 185	3.94 100	0.67 17	0.67 17	750 641	8	500/57	F07/F10
3" 80	3.15 80	8.1 205	4.37 111	0.67 17	0.67 17	1300 1111.1	11.5	650/73	F07/F10

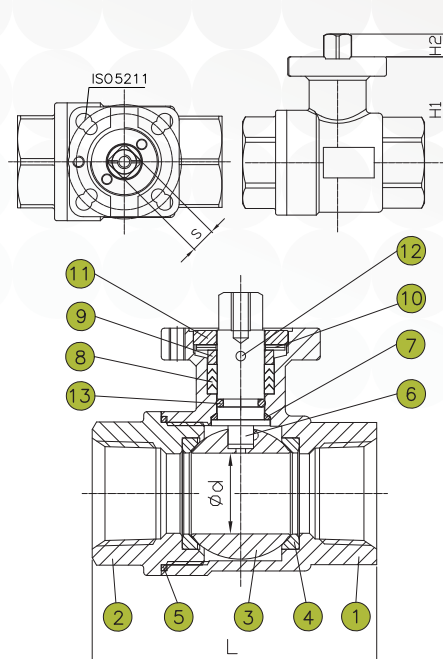

Optional Accessories

Automation Products

With the direct mount design, the Series 25(a) ball valves can be combined with every PVS FLOW CONTROL automatic control products without any troubles. Currently, PVS FLOW CONTROL offers two pneumatic actuator (Rack & Pinion type and Vane type) and Jexme electric actuator to accompany the Series 25(a) ball valves.

Various Handle Choices

For the Series 25(a) ball valves PVS FLOW CONTROL offers two types of handle options: original lever handle and oval handle. The lever handle with the vinyl sleeves is the standard equipment that is widely used. The vinyl can be customized to be different colors, words, and even simple graphics. The oval handle is used when the standard lever handle can be turned accidentally. The oval handle also allows user to identify the valve position. It also slows down the valve closing speed, which decrease the chances of water hammer on liquid.



How to order

VALVE TYPE	PORT	BODY MATERIAL	SEAT	TRIM	TYPE OF CONNECTION	PRESSURE RATING	SPECIAL REQUEST	SIZE OF CONNECTION	OTHER
A	B	C	D	E	F	G	H	I	J



Phone :86-21-52762825
 Email :sales@pvsflowcontrol.com
 Address :Floor2, Building D1,
 No.578, Lane1588,Zhuguang RD,
 Qingpu District,Shanghai,201702

PVS FLOW CONTROL Co.,Ltd.
<http://www.pvsflowcontrol.com>

Due to continuous development of the products, PVS FLOW CONTROL reserves the right to alter the dimension and information contained in the document as required. For specific performance data and proper material selection, please consult with your PVS FLOW CONTROL representatives